



Harshit
Chambers
Offices & Shops



Singhania Buildcon Group

Singhania Buildcon Group is one of the leading developers of residential commercial Hotel and Township in Raipur, Chhattisgarh. Since our foundation, we have offered our customers excellent returns on their real estate investment, Singhania Buildcon is synonymous with, ethics, transparency, customer service and a quality residential experience.

As one of the most renowned raipur developers, we have build Residential Apartment, Commercial Complexes, Hotels, Township and Villas that have revitalized the city of Raipur.

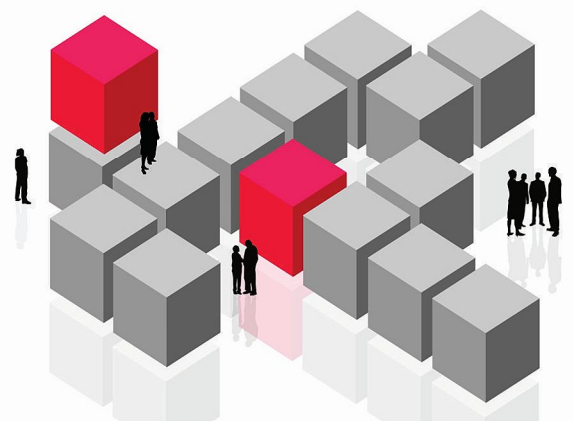



Harshit
Chambers
Offices & Shops

About The Project :

Harshit chambers is located in fully developed huge residential colony where shops and offices are in most demanding position. Harshit chambers will be a landmark for its surrounding area.





Harshit
Chambers
Offices & Shops



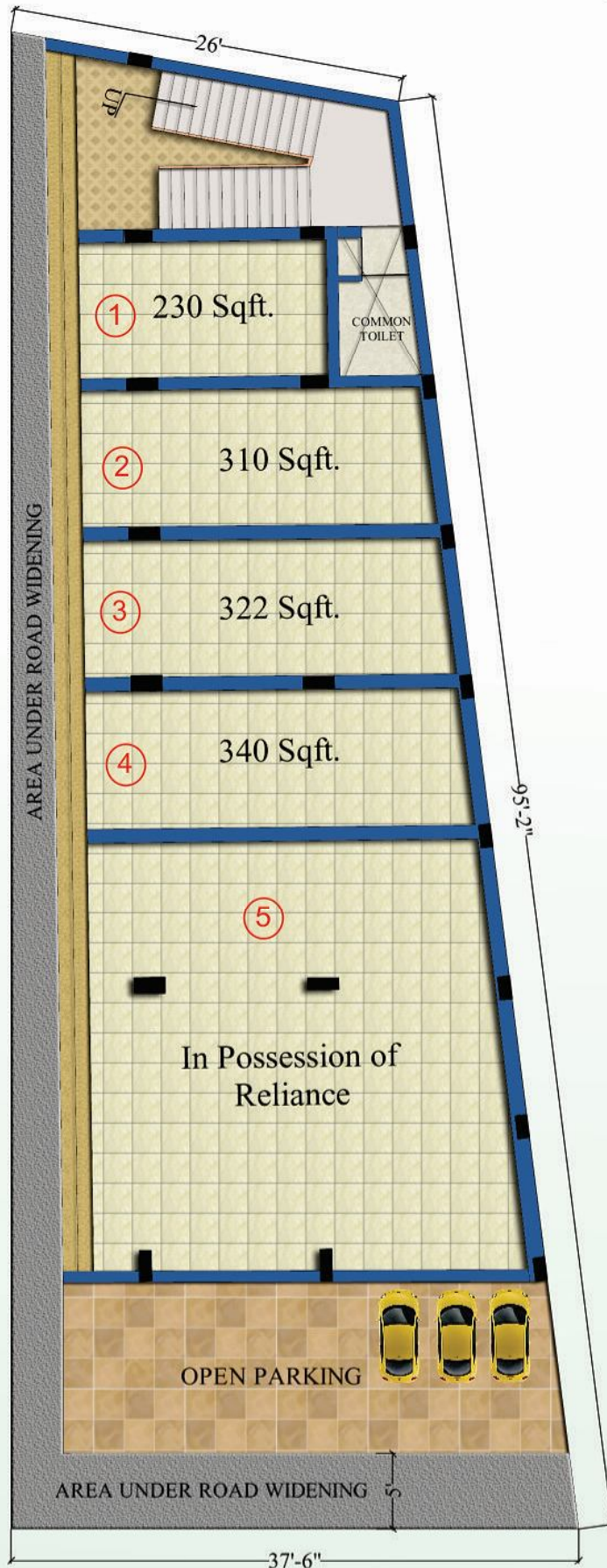

GROUND FLOOR PLAN



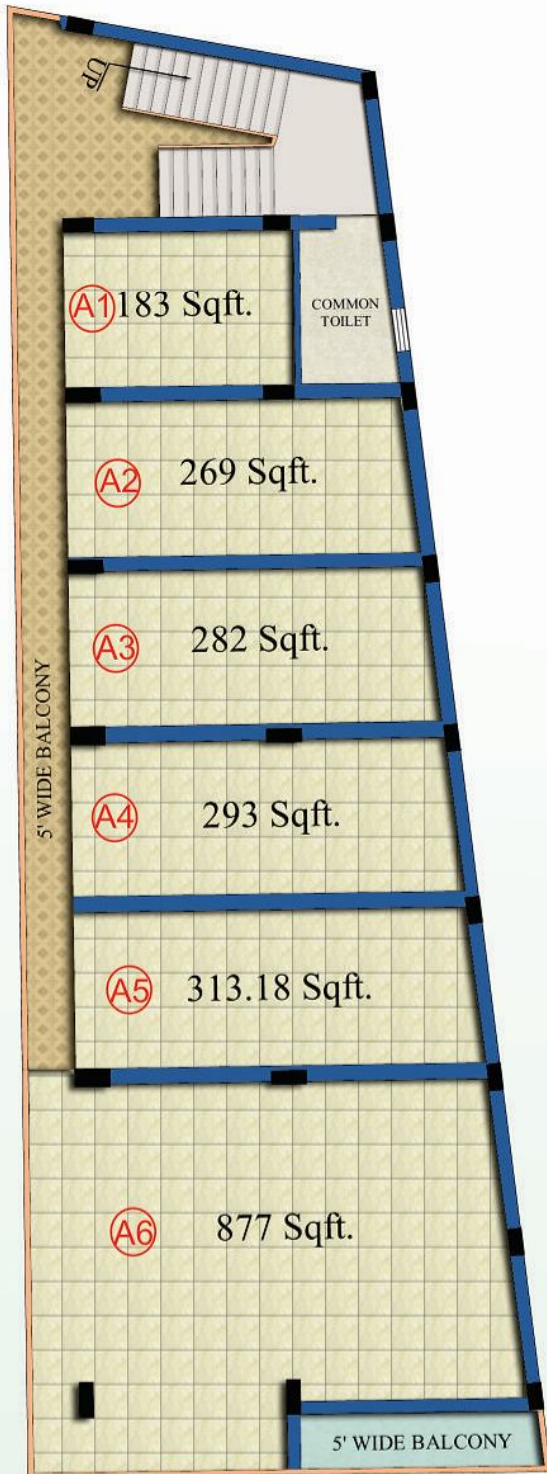

FIRST FLOOR PLAN

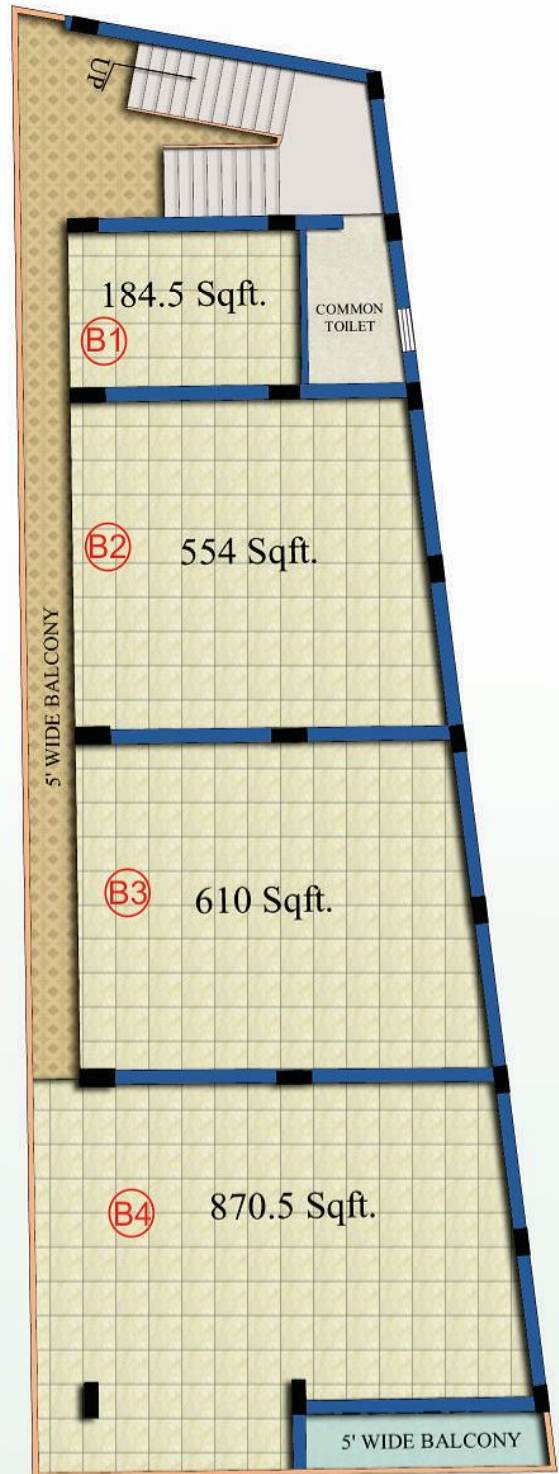

SECOND FLOOR PLAN



Amenities

- 24 hours security.
- Rain water Harvesting System.
- Common Toilet in ground floor & first floor.
- Power Point Provision for A.C.
- Open parking for two wheeler & four wheeler.
- 24 hour water supply.
- Sump Well.
- S.S. Railing.



Specification

Structure

R.C.C framed structure.
Exterior 9" Brick wall & Partition wall 4.5".

Doors & Windows

(First & Second Floor)

Main Door - Designer flush door.
Windows - Aluminum sliding windows.

Front Elevation

Covered with glass glazing and ACP work.

Wall Finishing

1. Internal wall with putty finish.
2. Primer & paints of branded make.

Ground Floor

Flooring : Vitrified tiles 2'X2' of branded quality.
Corridor : Granite tiles / anti skid tiles.
Shutter : Good quality M.S. Shutter.
Common toilet :-

1. Floor : Ceramic tiles of branded quality.
2. Wall tiles : Up to 8' height of branded quality.

First Floor

Flooring : Vitrified tiles 2'X2' of branded quality.
Corridor : Granite tiles / anti skid tiles.
Common toilet :-

1. Floor : Ceramic tiles 1'X1' of branded quality.
2. Wall tiles : Up to 8' height of branded quality.

Second Floor

Flooring : Vitrified tiles 2'X2' of branded quality.
Corridor : Granite tiles / anti skid tiles.
Attached toilet :-

1. Floor : Ceramic tiles 1'X1' of branded quality.
2. Wall tiles : Up to 8' height of branded quality.

Electrification

Concealed wiring (wires / cable of ISI mark and ISO certified reputed company) with modular switches.
A C point in offices.

OUR PROJECTS AT A GLANCE

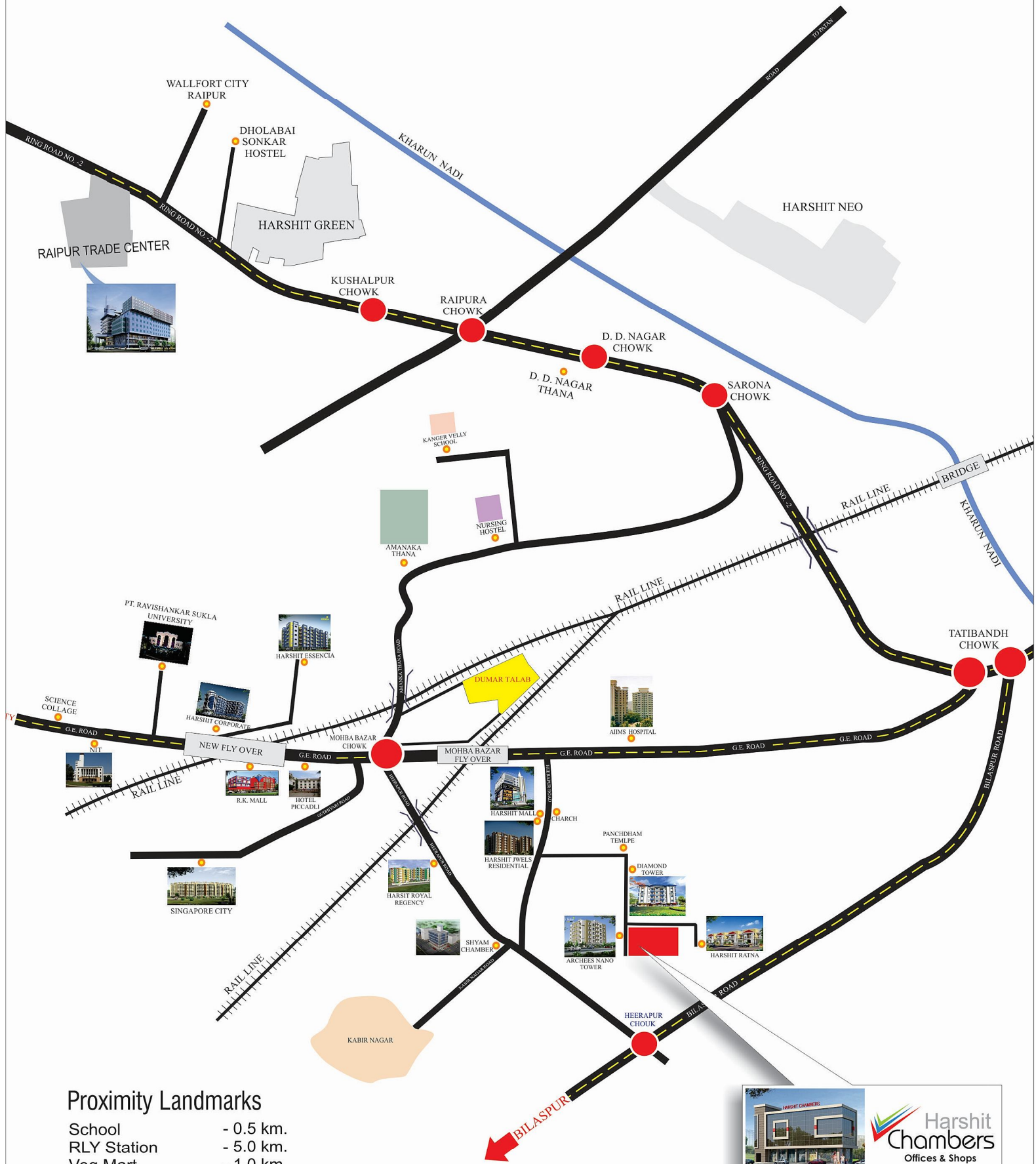

Proximity Landmarks

- School - 0.5 km.
- RLY Station - 5.0 km.
- Veg Mart - 1.0 km.
- N.highway - 0.5 km.
- AIIMS Hospital - 1.0 km.
- Busstop - 0.5 km.
- State Bank - 1.5 km.
- Jaistamb - 5.0 km.
- Pt.R.S. University. - 2.5 km.



Proposed Site

Our Ongoing Project's



Harshit Corporate



Raipur Trade Center



Archees Sarovar Portico



Harshit Chamber



Harshit Essencia



Harshit Pearl



Harshit Neo City



Harshit Icon City



Archee Icon City



Singapore City (Block 5,6,7)



Harshit Township

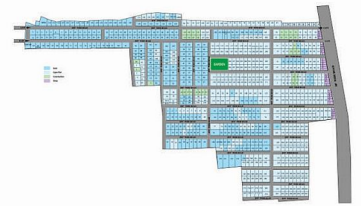

Harshit Vihar(Urkura)

Our Completed Project's



Harshit Diamond Tower



Harshit Jewels Residential



Archees Nano Tower



Harshit Ratna



Harshit Nagar



Shyam Chamber



Harshit Tower C-Complex



Club Marina



Singapore City (Block 1, 2,3,4)



Harshit Royal Regency



Archees Real Estate



Harshit Vihar (Urkura)



Harshit Tower (Block-A)



Harshit Tower (Block-B)



Harshit Tower (Block-X&Y)



Harshit Tower (Block-D)



SINGHANIA BUILDCON PVT. LTD.

HEAD OFFICE

3rd & 4th Floor Shyam Chamber, Heerapur Road, Mohaba Bazar
Raipur (C.G.), 492001, Ph. : 0771-2262421, 2262621, Fax : 2263821
Web.: www.singhaniabuildcon.com, E-mail : singhaniabuildcon@gmail.com



Architect

Bagrecha & Associates

1st floor, Indra lok apartment
Motibag Chouk to Rajbhawan Road Raipur (C.G.)
Phone: 2539070, Mo. : 98271 11022

Legal Advisor

Sudhir Agrawal

B-172-73, SEC.-5
Devendra Nagar, Raipur (C.G.)
0771- 4009001, Mo. : 96692 22296

For any enquiry call

9827 321 321, 9827 600 600